

DATA SPECIFICATION SHEET



RPSG-250W-PE (Peak Energy Series) POLYCRYSTALLINE PHOTOVOLTAIC MODULE



PRODUCT OVERVIEW

- **R&P Services Group's** modules are optimally manufactured and adjusted to meet and exceed the needs of the current market. The scientifically designed module dimensions will ensure an easy installation. Our module efficiency is 18%, and cell efficiency is 16.2%. We only deliver modules with positive tolerance up to +4.99Wp.
- **R&P Services Group's** continuous efforts in product quality control, yearly updates of our certifications, and commitments to our R&D for the latest technologies; is visible in all of our top quality, Grade A, Polycrystalline Photovoltaic Modules. We take pride in manufacturing all of our products under our own RPSG OEM brand.

MODULE CHARACTERISTICS

- High efficiency Polycrystalline silicon Photovoltaic cells.
- High transmission low iron tempered glass, strong mechanical resistance.
- TUV certified waterproof junction box, bypass diode, and MC4 connectors.
- High endurance to different atrocious weather conditions.
- Individually tested to ensure product's advertised properties and power outputs.

MECHANICAL PARAMETERS

Cell(mm) Poly 156×156

Weight(kg) 19

Dimensions(LxWxH)(mm) 1650X990X40 (64.96X38.98X1.57 inches)

Cable Length(mm) ≥900(35.43 inches)+MC4 connectors

Cable cross section size(mm²) 4(0.157 inches)

No. of cells and connections 60 (10×6)

No. of diodes 3/6

Packing configuration 21pcs/carton

Fire safety class Class C

WORKING CONDITIONS

Maximum System Voltage DC 1000V

Operating Temp. -40°C~+85°C

Maximum Series Fuse (A) 15

Static loading ≥2400Pa

Grounding conductivity ≤0.1Ω

NOCT 45±2°C

Application Class Class A

Insulation Resistance ≥100MΩ

Safety application class Class II

GUARANTEE

10-year limited product warranty.

Limited performance warranty: 10 years at 90% of the minimal rated power output, 25 years at 80% of the minimal rated power output.

DATA SPECIFICATION SHEET



RPSG-250W-PE (Peak Energy Series) POLYCRYSTALLINE PHOTOVOLTAIC MODULE

ELECTRICAL PARAMETERS	
OEM Part Number	RPSG-250W-PE
Pmax(w)	250 (0~+5%)
(Voc/V)	37.8
(Vmp/V)	30.5
(Isc/A)	8.85
(Imp/A)	8.20
Power Tolerance	0~+5%
α Isc	+0.04%/°C
β Voc	-0.3%/°C
γ Pmp	-0.44%/°C
STC	AM1.5, 1000W/m ² , 25°C

I-V CURVE

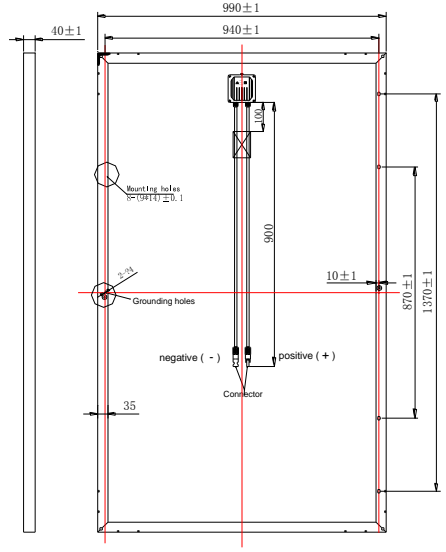
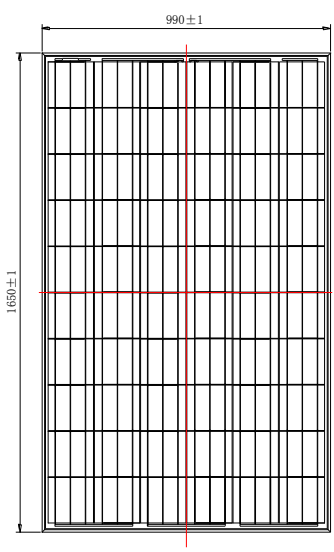
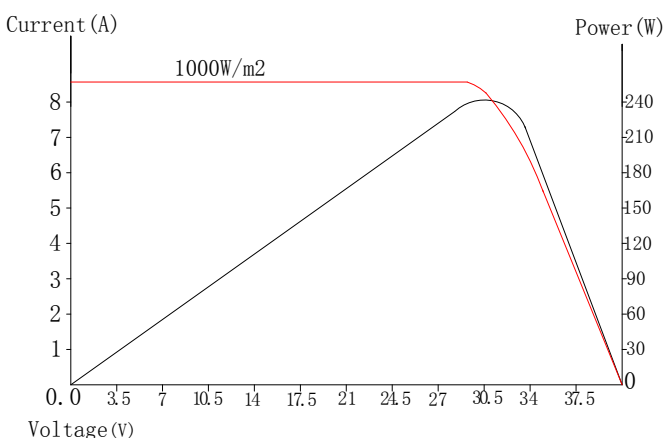

R&P Services Group
 8424 N.W. 66th Street
 Miami, FL 33166 – (USA)
 Tel: +1(786)930-4545
 www.rpsg.solar
 info@rpsg.solar

